

- 1.....WIRING HARNESS
- 2.....OVERHEAD SWITCH PANEL
- 3.....INSTRUMENT PANEL
- 4.....FUEL PUMPS
- 5.....BATTERY
- 6.....CYCLIC HANDLE (START BUTTON)
- 7.....IGNITION MODULES
- 8.....IGNITION SENSORS
- 9.....STARTER
- 10.....STARTER RELAY
- 11.....FUEL SENDER
- 12.....ROTOR TACH SENSOR
- 13.....ALTERNATOR
- 14.....OIL PRESSURE HOSE
- 15.....MANIFOLD PRESSURE HOSE
- 16.....RADIO ANTENNA WIRE (OPTIONAL)
- 17.....HOUR METER (MOUNTED ON FLOOR)
- 18.....FULL RANGE TACH (MOUNTED ON FLOOR)

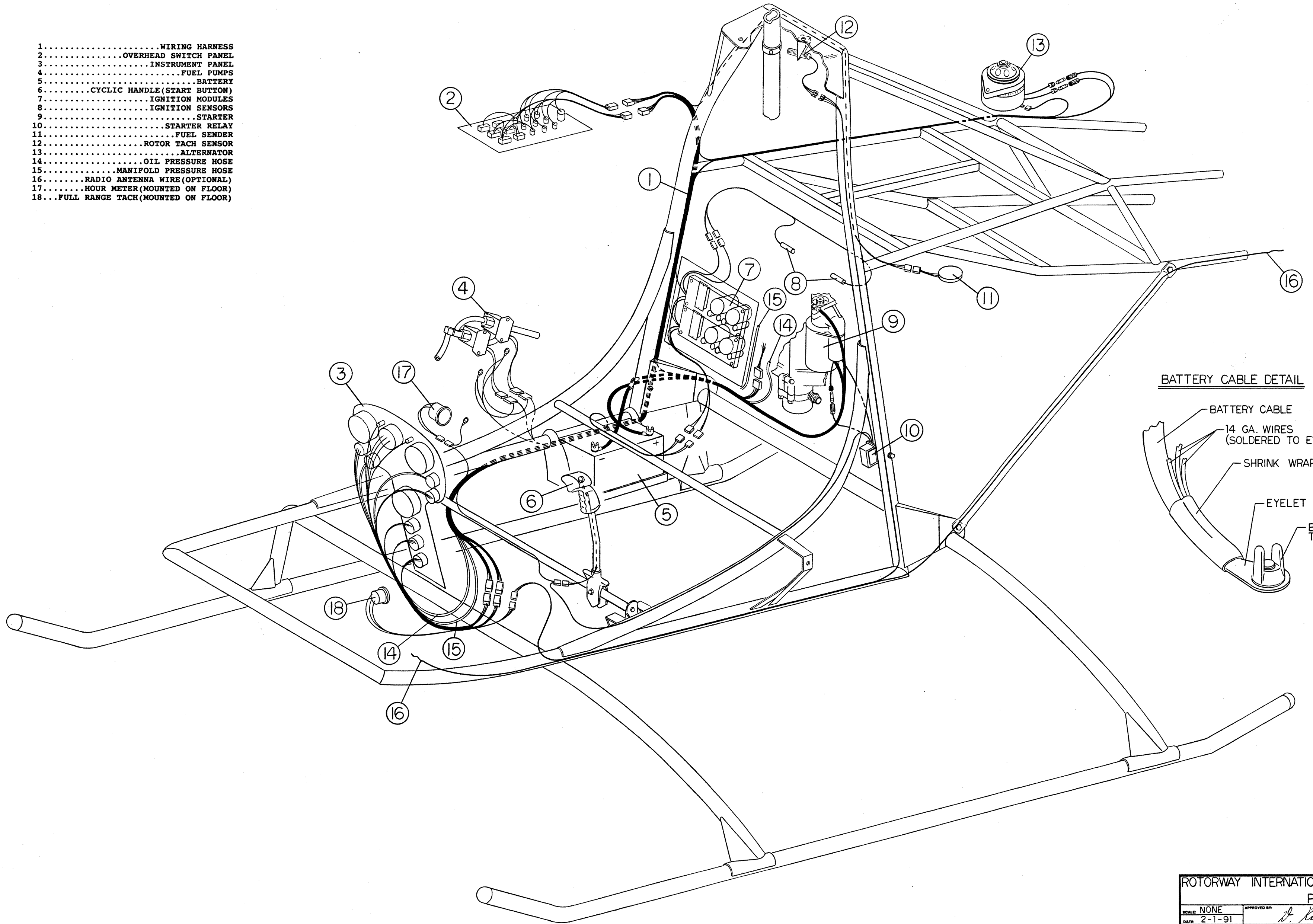

BATTERY CABLE DETAIL

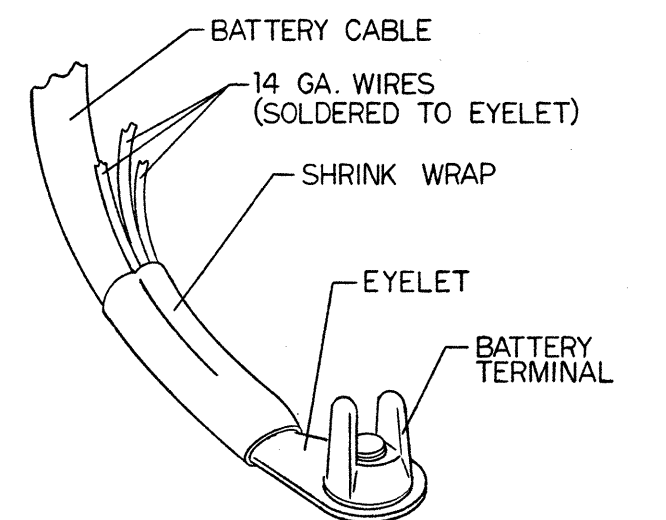

ROTORWAY INTERNATIONAL		PHOENIX, ARIZONA	
SCALE: NONE	APPROVED BY: <i>D. King</i>	DRAWN BY: WAR	REVISED: 2-1-93
DATE: 2-1-91	WIRING HARNESS		DRAWING NUMBER: E35-2000-1

2-1-93 REVISION 1: ADD FULL RANGE TACH(18)